

# Grosse Ile Township Nature Trail Guide

*Published 2009*



The residents of Grosse Ile possess a unique natural public treasure. By preserving undeveloped land, we have the opportunity to enjoy a piece of Michigan's natural heritage.

To aid in your enjoyment of this treasure, the Open Space Committee in cooperation with the Grosse Ile Garden Club has prepared a guide of three existing nature trails.

We hope that you will enjoy walking these trails. We ask that you use them responsibly by confining your visits to daylight hours, take nothing but pictures and leave nothing but footprints. We encourage you to pick up any trash you may find, and report any unwelcome activities or events to Township authorities.

Enclosed is a questionnaire requesting your comments and suggestions. Please take a few moments to complete the questionnaire and mail it to the Grosse Ile Township c/o the Open Space Committee. If you prefer, you may email your comments to [carolk@grosseile.com](mailto:carolk@grosseile.com).

# Grosse Ile Trails

## Wild Life Sanctuary

The Wild Life Sanctuary is Township land which has been under the stewardship of the Grosse Ile Garden Club since the late 1940s. It is located on the north side of Horsemill and to the east of Thorofare. There are two entrances, one on Horsemill about 130 yards east of Thorofare, and one on Morkland about 100 yards east of Thorofare.

The trail is about 350 yards in length and partially covered with wood chips. The area is heavily forested with many large trees and a view of the Thorofare Canal. Points of interest are described below, and referred to in the map.

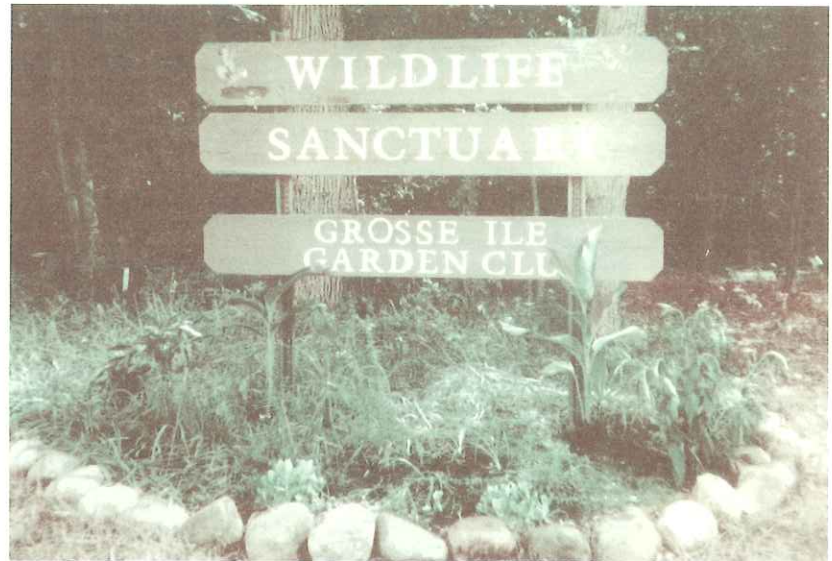

1. Sanctuary Sign at Horsemill
2. Trail Entrance on Horsemill
3. Trail Entrance on Morkland
4. Walking Trail
5. Thorofare Canal Overlook

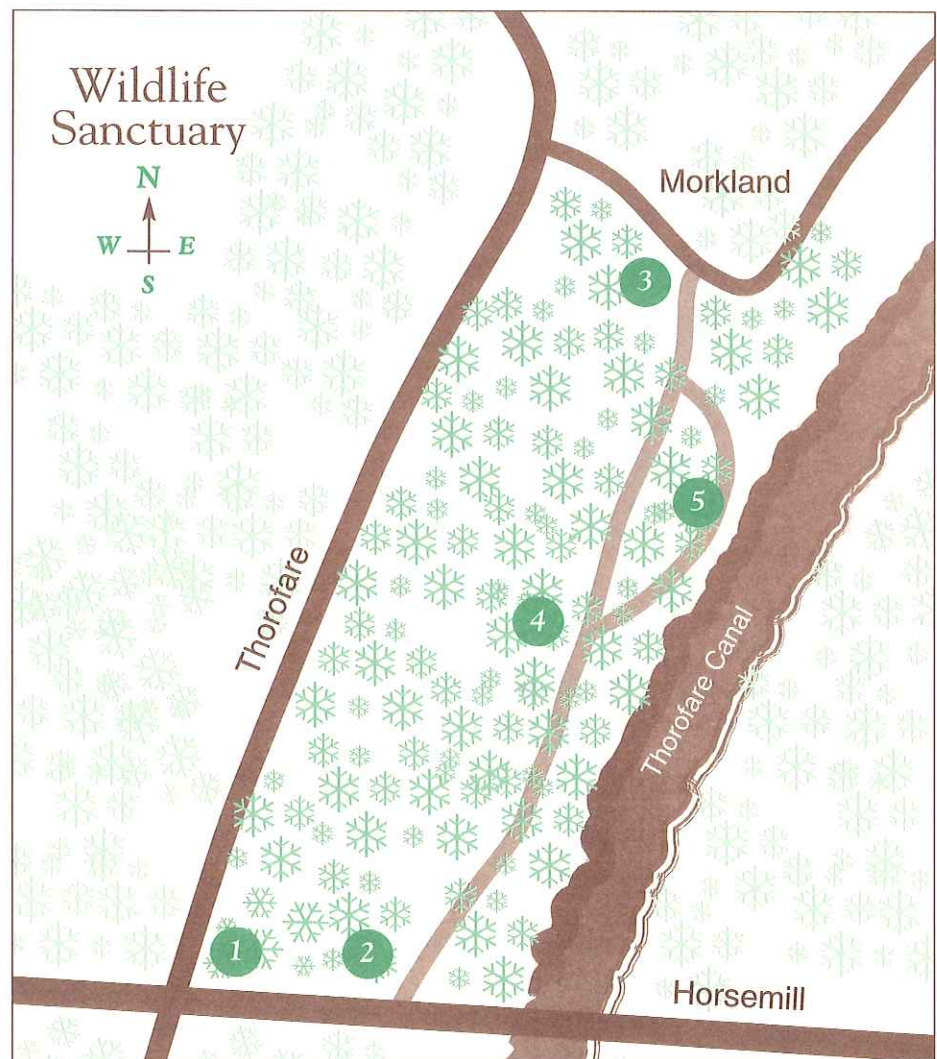

# Grosse Ile Trails

## 80 Acre Woods

The 80 acre woods trail is located in the open space on the east side of Meridian Road across from the Meridian Elementary School. The entrance is identified by a small berm with two evergreen trees. It is a closed-loop natural trail about 400 yards long with low spots and logs. It is heavily forested with large trees. You will probably see deer while walking the trail. Since the trail is undeveloped, some of the logs will be across the trail. Also be aware of poison ivy.



1. Trail entrance
2. Logs across trail
3. Large maple tree with some poison ivy
4. Low spot - you may see some frogs
5. Large tree - trail makes a loop

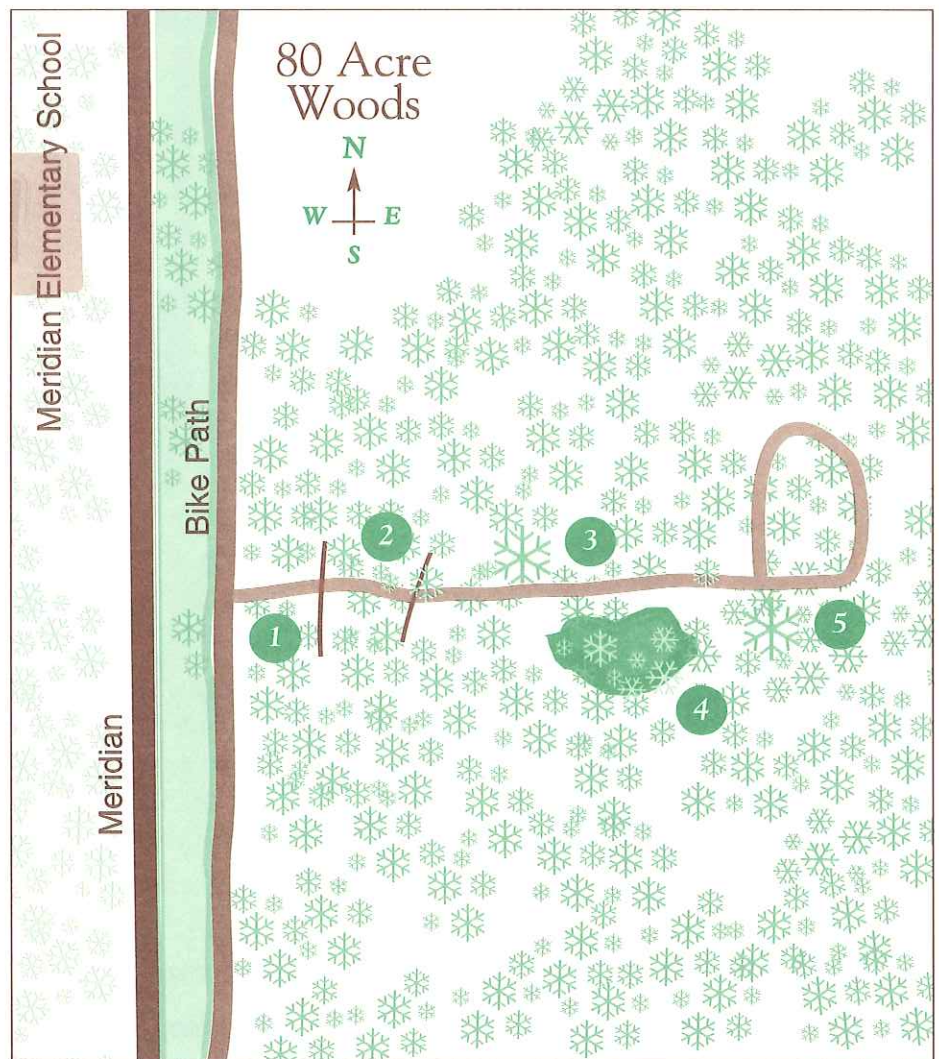

# Grosse Ile Trails

## Playscape Trail

The Playscape Trail is located in the open space area directly west of the Playscape behind the Post Office. It is a closed-loop trail about 280 yards in length with wood chips. It was constructed by a local Boy Scout to obtain his Eagle Scout badge. The area is heavily forested and contains deer runs across the trail. It is an ideal trail to take your children or grandchildren after visiting the Playscape.

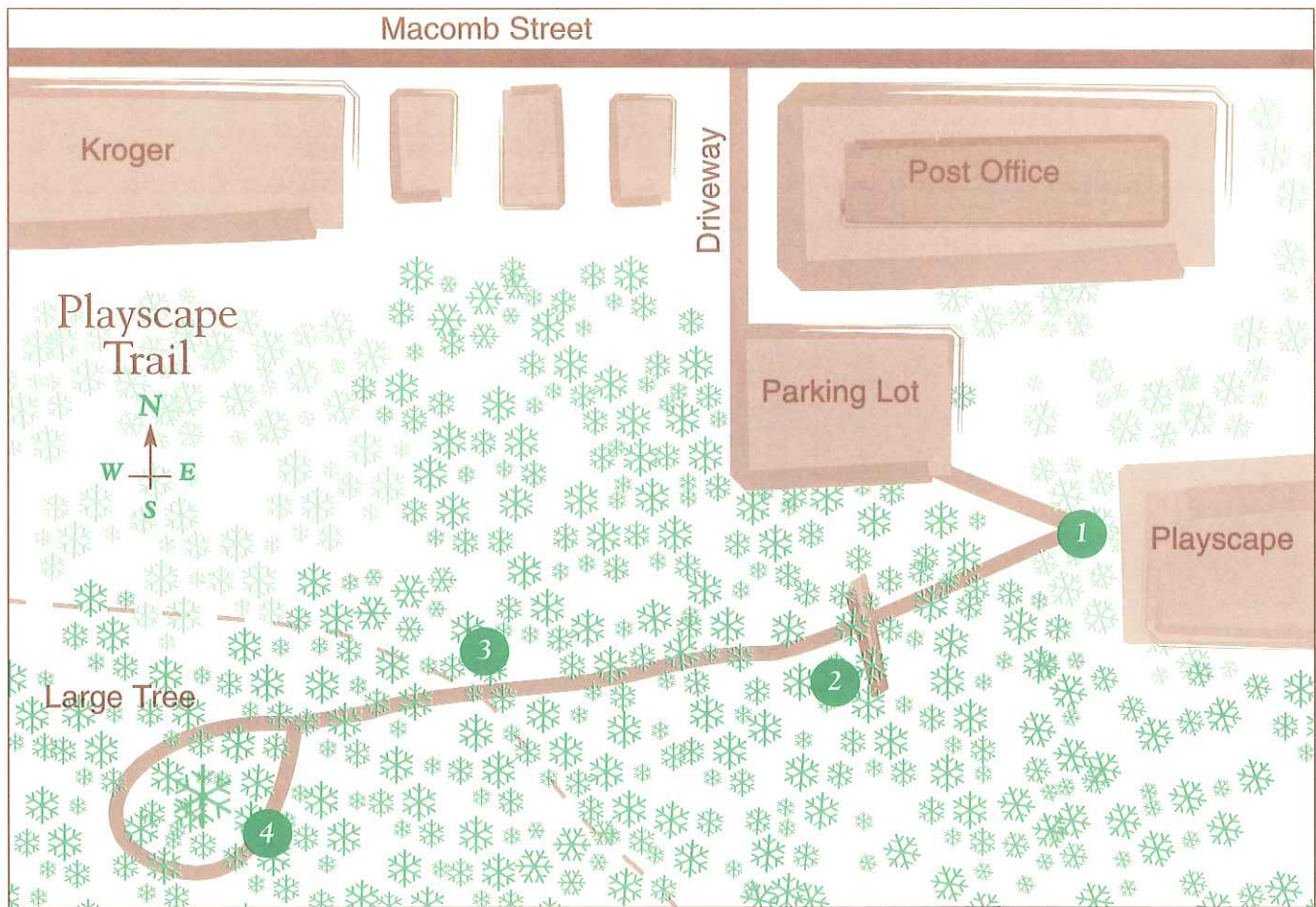

1. Trail entrance west of Playscape
2. Culvert covering small creek
3. Deer run
4. Trail loop around large tree

# Nature Trails Questionnaire

Please write your comments and/or suggestions in the spaces provided below:

## Wildlife Sanctuary

---

---

---

---

---

---

---

---

## 80 Acre Woods

---

---

---

---

---

---

---

---

## Playscape Trail

---

---

---

---

---

---

---

---